

REQUEST FOR PROPOSAL

Project Title: Cooley Laboratory Renovation
Location: Montana State University

PPA No.: 10-0023
RFP No.: 107
Date: April 24, 2013

To: Dick Anderson Construction
4498 Jackrabbit Lane
Bozeman, MT 59718

Attention: Platisha

From: Cecilia Vaniman, Project Manager
Cooley Lab Renovation
Montana State University

Attention: _____

In order to expedite the Work and avoid or minimize delays in the Work the following information is requested. Please return a response by: 04/30/2013 Date Sent: 04/25/2013
Date Received: _____

Proposal Requested:

RELOCATE EXISTING DOOR 314a INTO OPENING BETWEEN 005E AND 029

Scope of work includes; Division 08 & 09

Install Existing Door from 310 into opening between Room 005E and 029.
Area is extremely sensitive to any dust. Provide maximum dust protection while performing ALL phases of work.

- The opening is 48 + inches wide and slightly less than 7'-0" tall.
- The Door will require patching where the closer was attached.
- The door frame will need to be reduced to fit the opening (Lower the head of the door frame)
- Wall infill at the new door location to be metal stud and Birch Plywood to match the door.
- Add Lockset 93K7 D 15D S3 Key side to be Room 029

ATTACHMENTS: CRV Skeetch 04/25/2013

This RFP is for pricing purposes only. The contractor shall not proceed with the scope of work described within until pricing is approved by the owner in writing.

Distribution: Owner Architect Engineer
 Agency Contractor Other

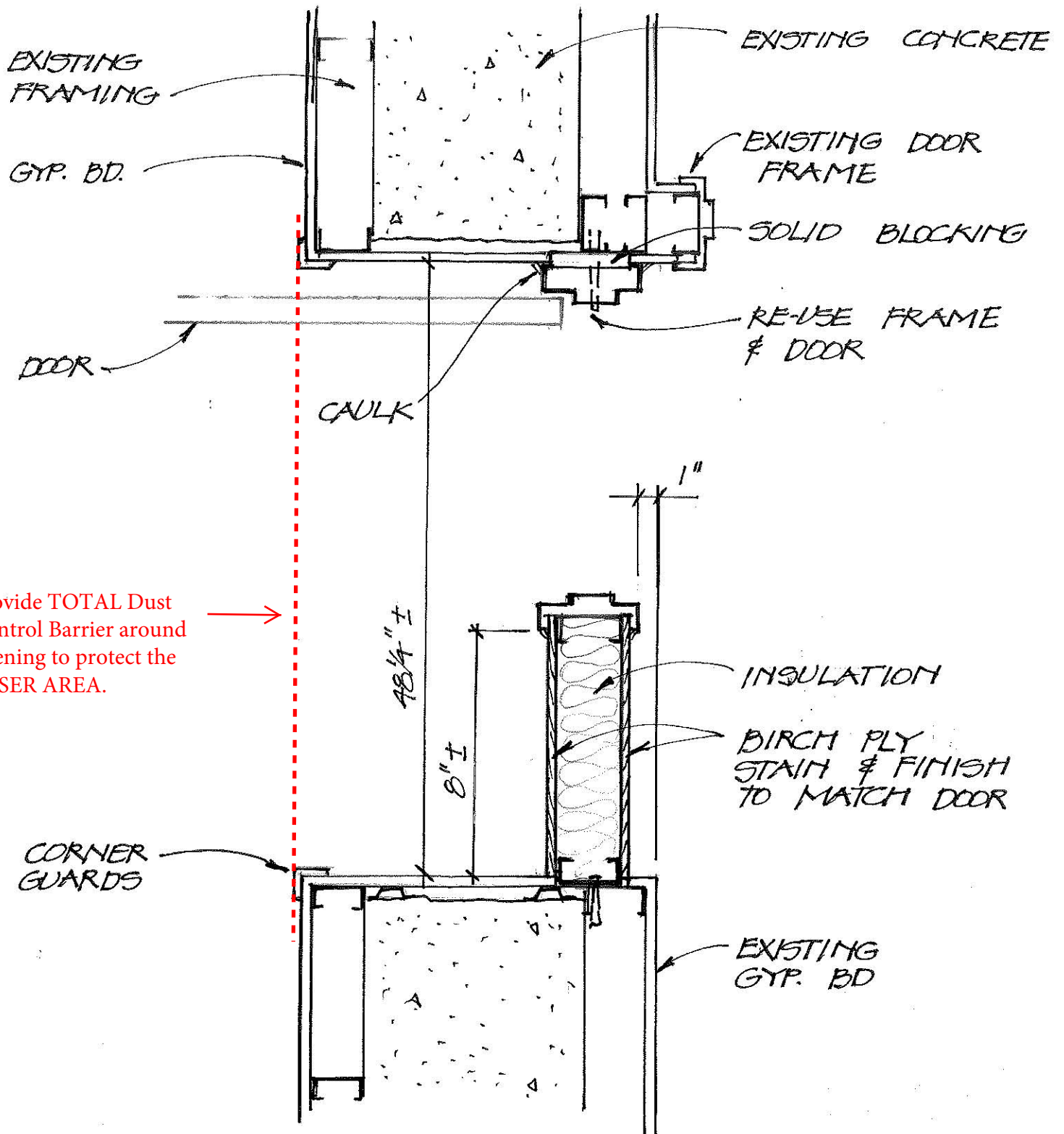

Provide TOTAL Dust Control Barrier around opening to protect the LASER AREA.

COOLEY • NEW DOOR BETWEEN
005 E & 029

CRV 4-25-2013 REV.