

RFI 39 A

Project: COOLEY LABORATORY RENOVATION
Job: 3146 COOLEY LAB, PPA# 10-0023
Customer: STOFMT MSU BOZEMAN
Issued To: CONSTRUCTION MANAGEMENT SERV.
P.O. BOX 7274
BOZEMAN, MT 59715

POTENTIAL IMPACTS
Cost Impact: Yes
Schedule Impact: No

Attention: DONALD J. PLATISHA
Phone/Fax: 406 585-0611 / 406 585-2698
Coordination copies to:

Item: Window Versus Ceiling Height Type: ARCH/STRUC
Reference: A2.2, A2.3 Spec. Section:
Attachments:

Description of Request

QUESTION:
The aluminum windows are +/- 9'-0" A.F.F. to the top, the drop ceilings in the offices on the 2nd floor and office 315 are 8'-0" A.F.F.

RECOMMENDATION:
Provide an alcove at the windows in the offices on the 2nd floor please provide detail, an alcove at the third floor is not feasible due to duct work running tight wall, due to this we recommend spandrel glass or no drop ceiling in office 315.

Respond By: 10/05/11 By: TIM THOLT

Response

FURTHER TO OUR INITIAL RESPONSE AND DISCUSSIONS WITH MSU. WE OFFER THE FOLLOWING CLARIFICATION DRAWINGS (CD-5.0 THROUGH 5.5 DATE 10-19-11) THAT ILLUSTRATE THE USE OF A DROPPED STEEL STUD HEADER SUPPORTED FROM THE SLAB ABOVE. THE HEADER IS TO BE WRAPPED WITH GWB AS SHOWN.

THE WINDOW HEAD DETAIL 5/A8.1 CAN BE MODIFIED AS NEEDED TO ACCOMMODATE THE CEILING WALL ANGLE. THE INTENT ON THE SECOND FLOOR IS TO EXTEND THE HIGHER CEILING AS FAR NORTH AS IS POSSIBLE GIVEN THE CEILING MOUNTED M&E PIPING AND EQUIPMENT.

Signed: FRANK JOHN DI STEFANO Date: 10-20-11

Proceed as Indicated: _____ Date: _____

Owner Authorized Representative

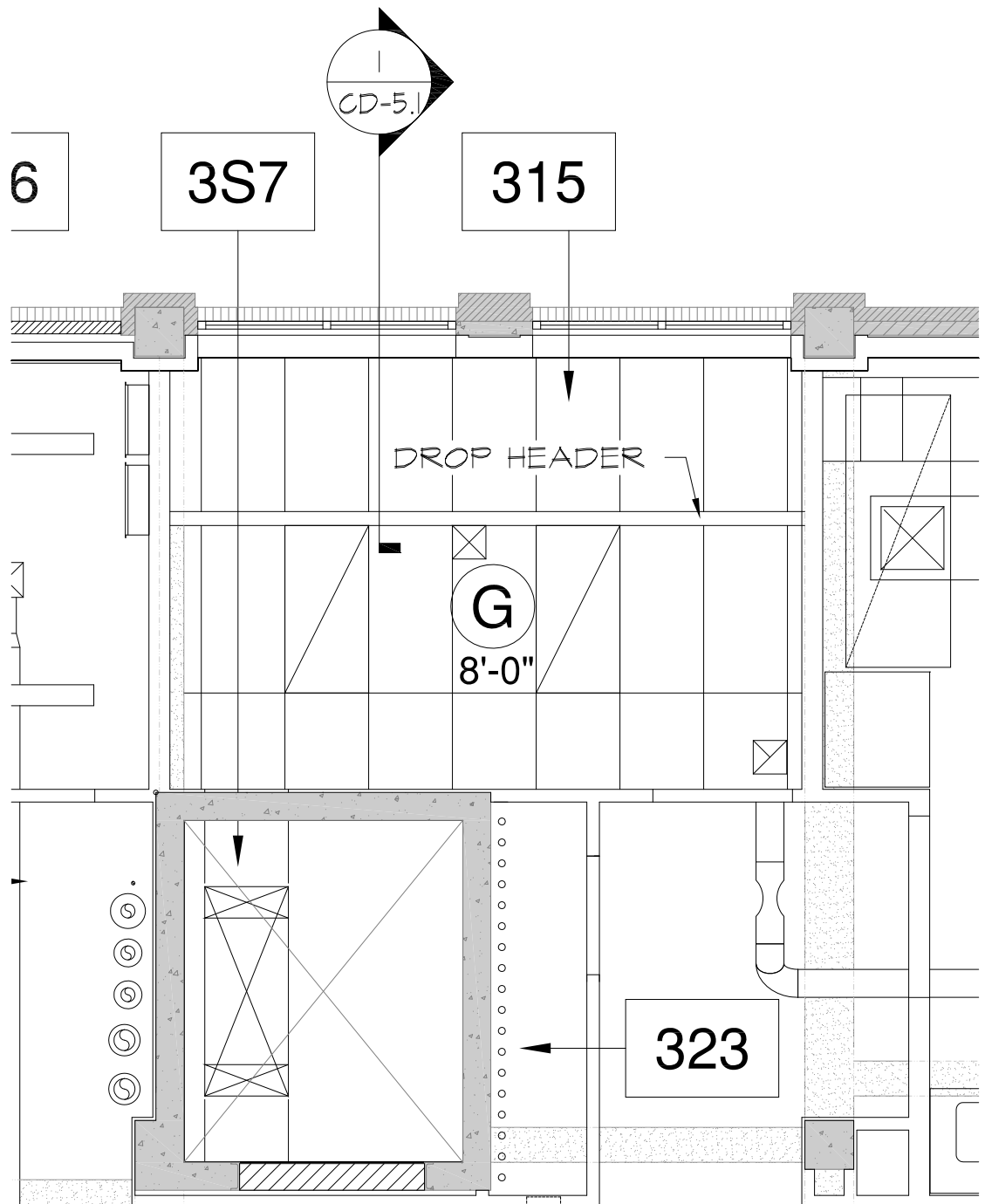

REFLECTED CEILING PLAN: FLOOR 3

SHEET A2.3



**Architects
Design
Group PC**

1 SUNSET PLAZA . KALISPELL, MONTANA
P 406.257.7125
E architects-design-group.com

Cooley Laboratory Remodeling

Bozeman, Montana
MSU PPA 10-0023
N.I.H. - N.C.R.R. Grant 1CO6RR30426

ADG Project 10-020

Clarification Drawing

CD-5.0

Date: 10.19.2011
Drawing Scale: 3/4" = 1'-0"

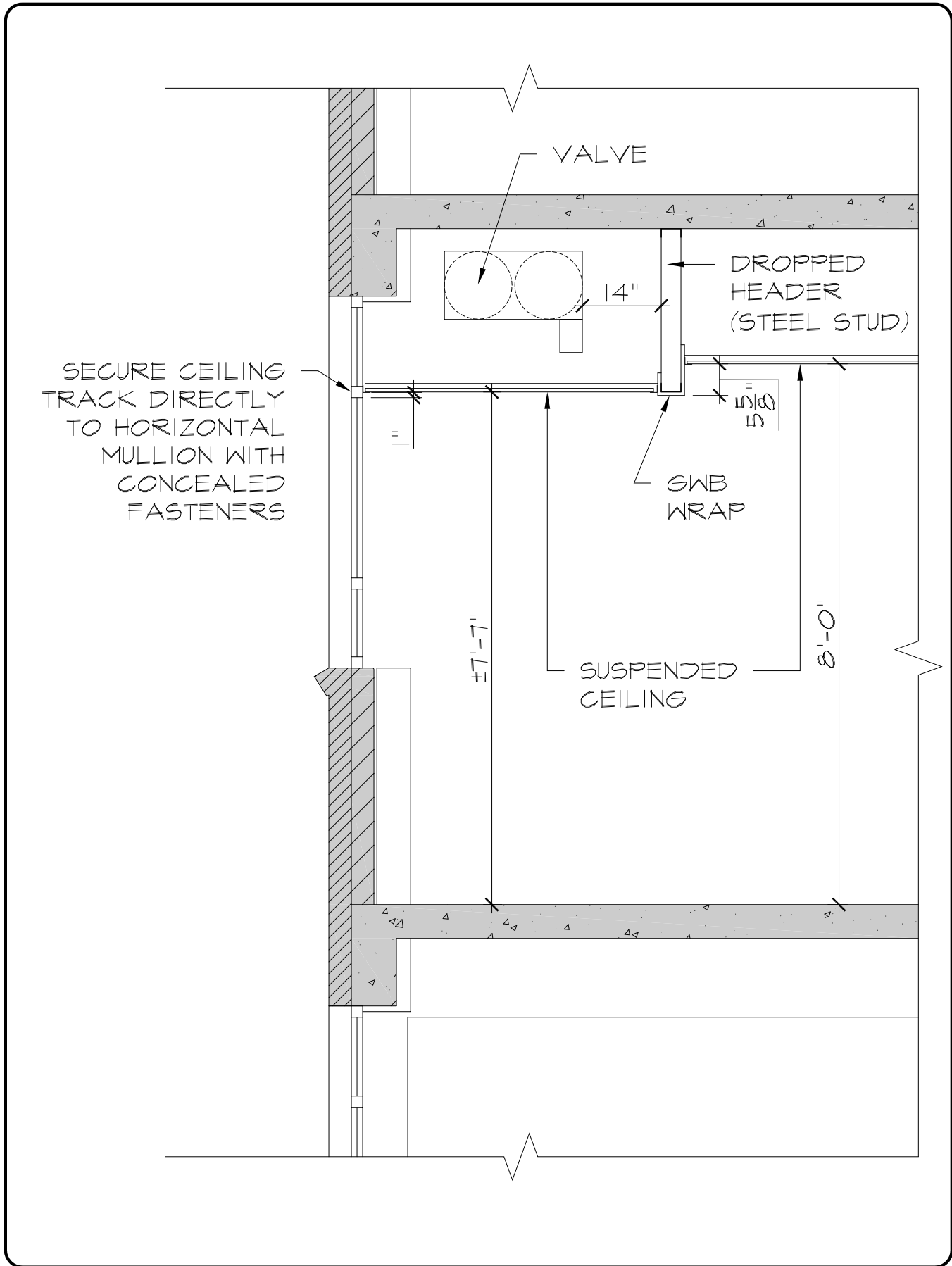

**Architects
Design
Group PC**

1 SUNSET PLAZA . KALISPELL, MONTANA
P 406.257.7125
E architects-design-group.com

Cooley Laboratory Remodeling

Bozeman, Montana
MSU PPA 10-0023
N.I.H. - N.C.R.R. Grant 1CO6RR30426

ADG Project 10-020

Clarification Drawing

CD-5.1

Date: 10.19.2011
Drawing Scale: 3/8" = 1'-0"

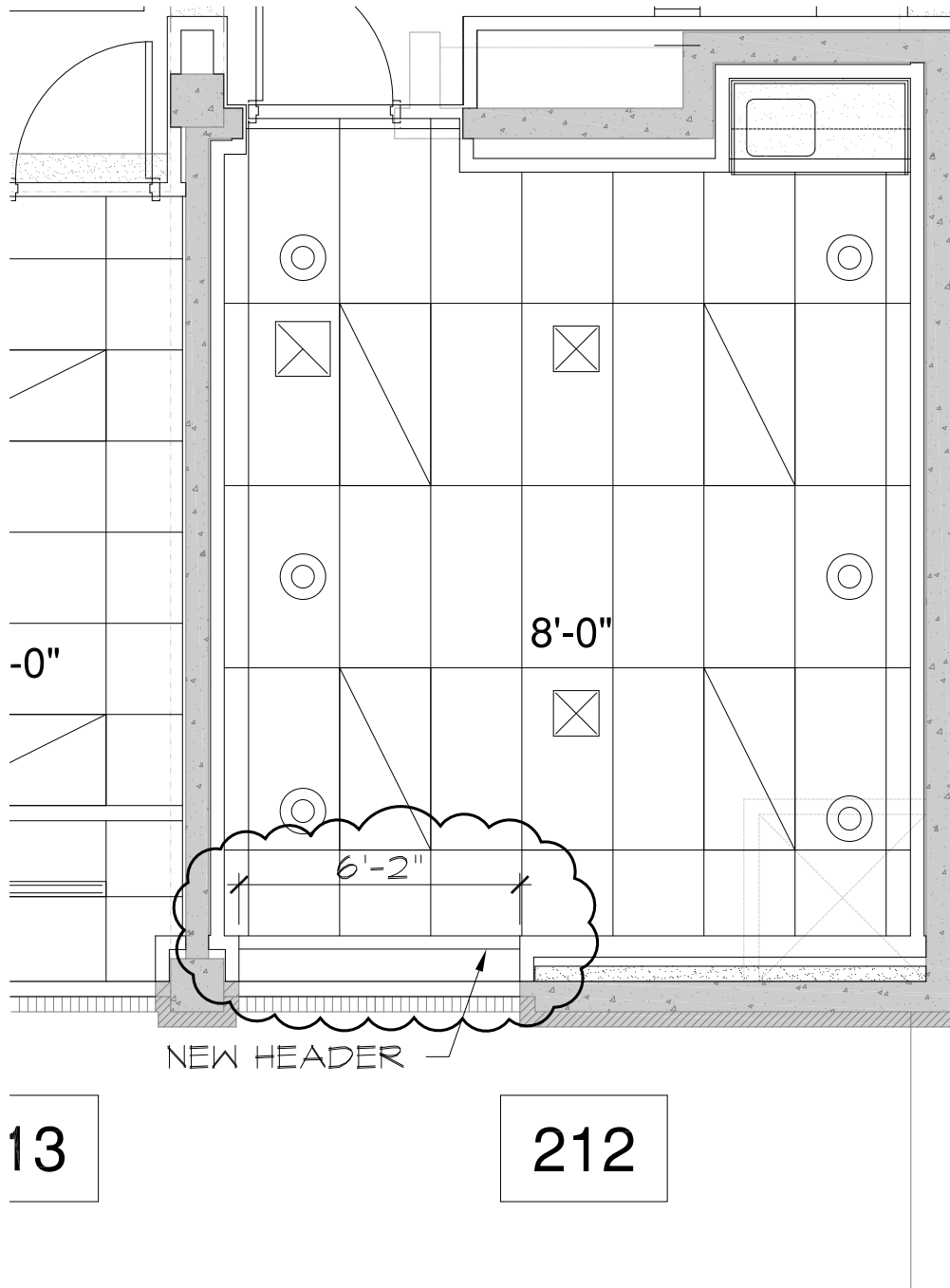

REFLECTED CEILING PLAN: FLOOR 2

SHEET A2.2



**Architects
Design
Group PC**

1 SUNSET PLAZA . KALISPELL, MONTANA
P 406.257.7125
E architects-design-group.com

Cooley Laboratory Remodeling

Bozeman, Montana
MSU PPA 10-0023
N.I.H. - N.C.R.R. Grant 1CO6RR30426

ADG Project 10-020

Clarification Drawing

CD-5.2

Date: 10.19.2011
Drawing Scale: 1/4" = 1'-0"

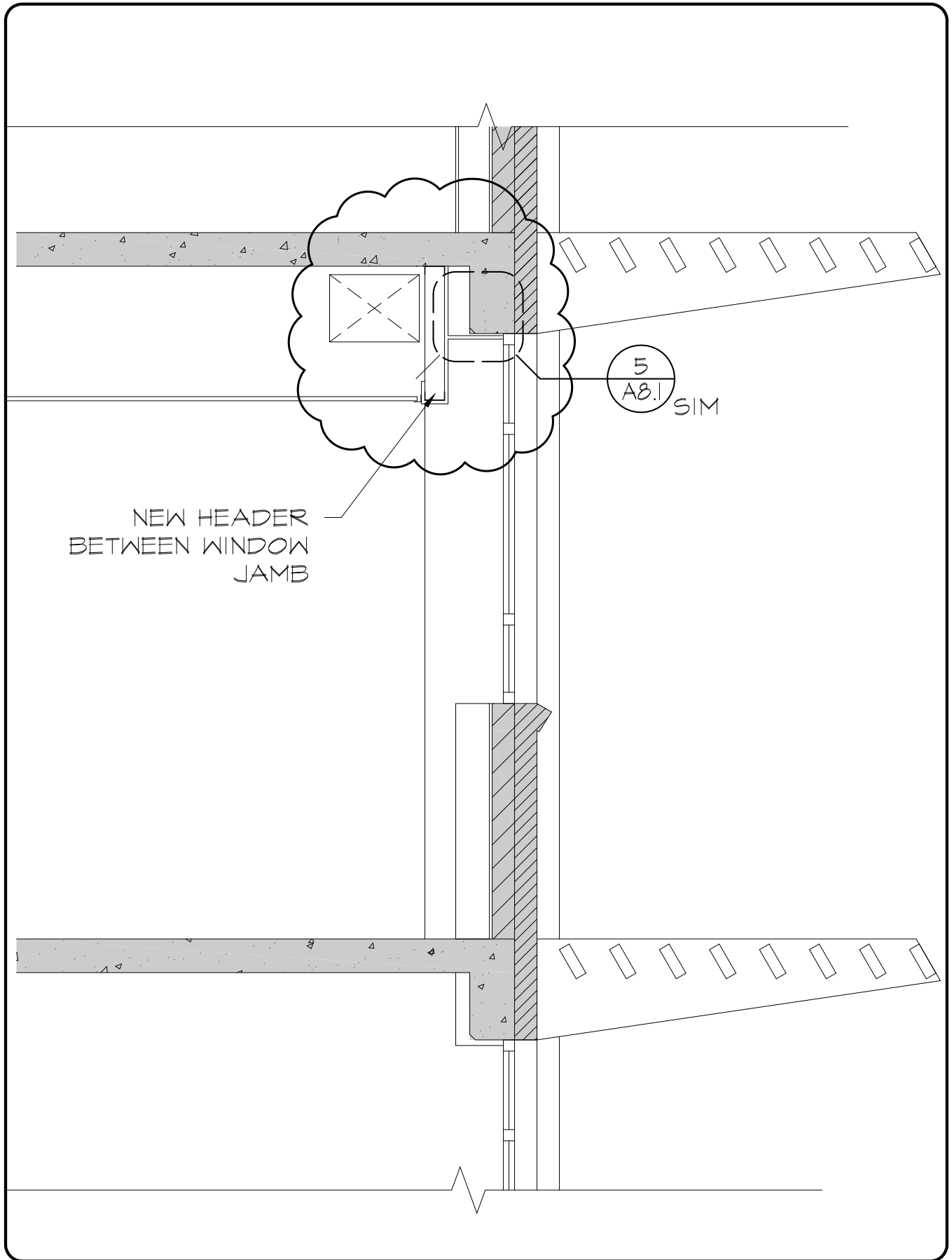

**Architects
Design
Group PC**

1 SUNSET PLAZA . KALISPELL, MONTANA
P 406.257.7125
E architects-design-group.com

Cooley Laboratory Remodeling

Bozeman, Montana
MSU PPA 10-0023
N.I.H. - N.C.R.R. Grant 1CO6RR30426

ADG Project 10-020

Clarification Drawing

CD-5.3

Date: 10.19.2011
Drawing Scale: 3/8" = 1'-0"

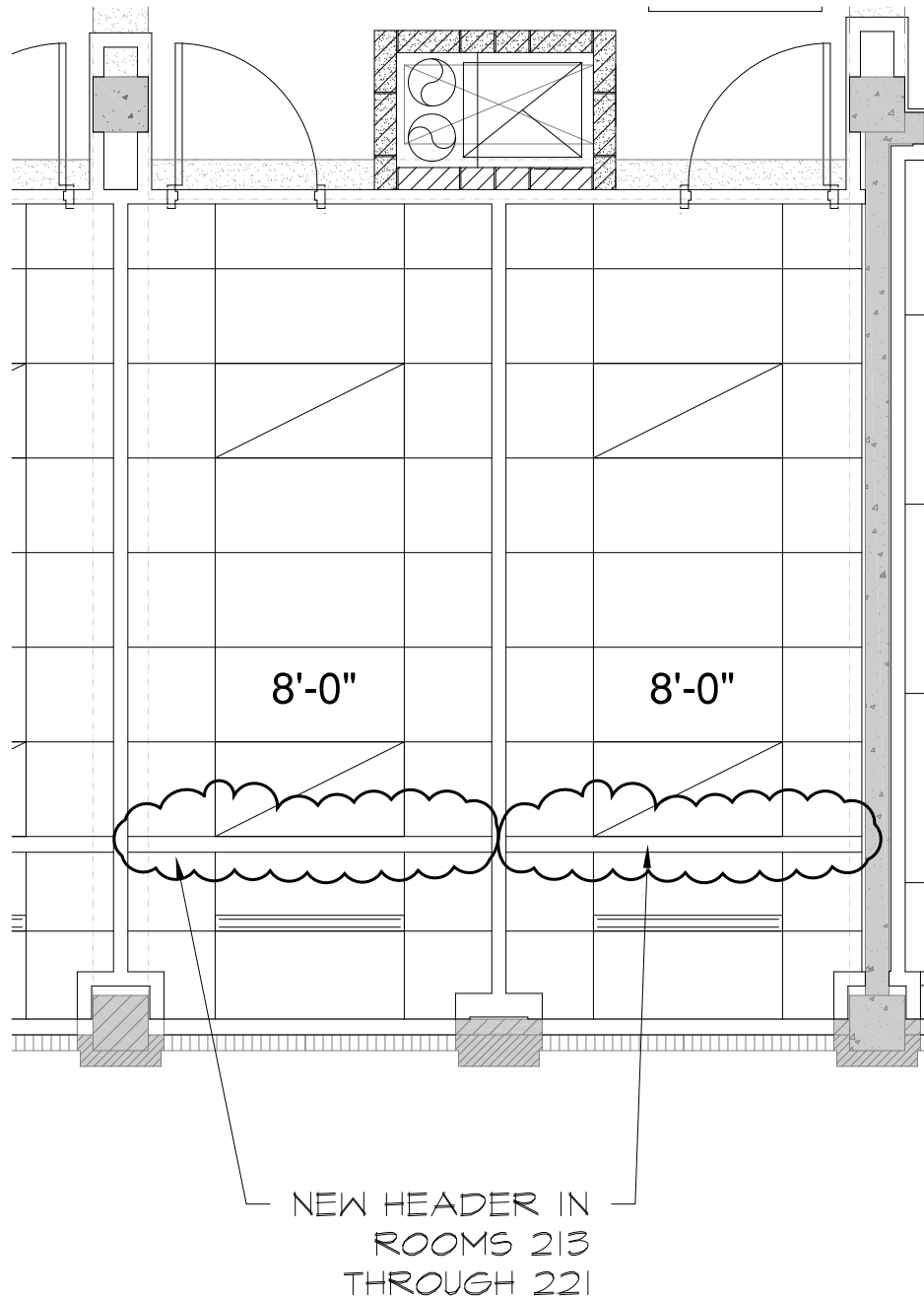

(H) ~~[N] SUSPENDED ACOUSTIC PANEL CEILING SLOPES IN FIRST PANEL AT WALL FROM WINDOW HEAD TO FIELD HEIGHT~~

REFLECTED CEILING PLAN: FLOOR 2

SHEET A2.2



**Architects
Design
Group PC**

1 SUNSET PLAZA . KALISPELL, MONTANA
P 406.257.7125
E architects-design-group.com

Cooley Laboratory Remodeling



Bozeman, Montana
MSU PPA 10-0023
N.I.H. - N.C.R.R. Grant 1CO6RR30426

ADG Project 10-020

Clarification Drawing

CD-5.4

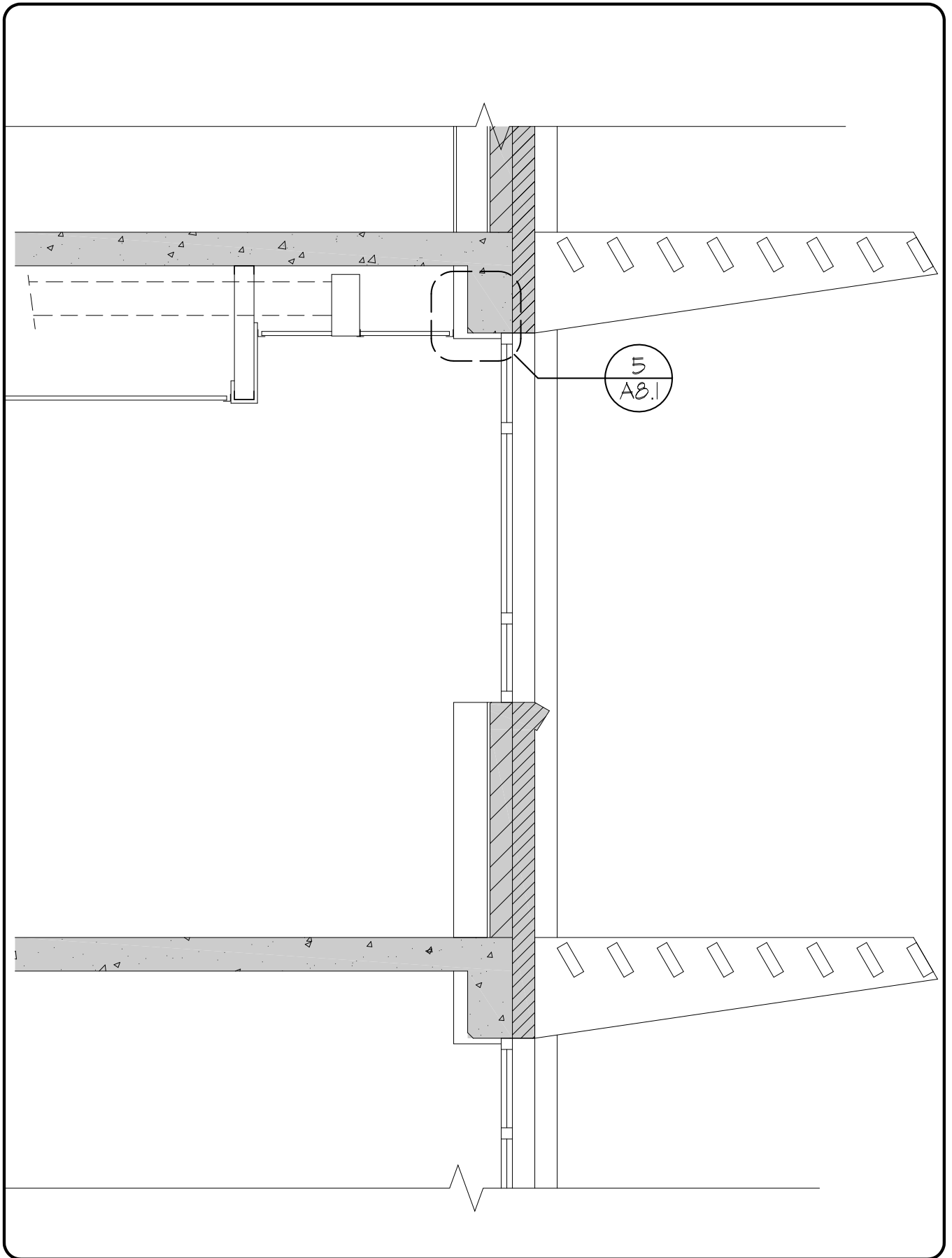
Date: 10.19.2011
Drawing Scale: 3/4" = 1'-0"

**Architects
Design
Group PC**

1 SUNSET PLAZA . KALISPELL, MONTANA
P 406.257.7125
E architects-design-group.com

Cooley Laboratory Remodeling
Bozeman, Montana
MSU PPA 10-0023
N.I.H. - N.C.R.R. Grant 1CO6RR30426
ADG Project 10-020

Clarification Drawing
CD-5.5

Date: 10.19.2011
Drawing Scale: 3/8" = 1'-0"